

P1	ISSUE FOR DA	15.05.18	NH
P2	ISSUE FOR DA	17.05.18	NH

EROSION AND SEDIMENT CONTROL NOTES

- All work shall be generally carried out in accordance with
 - Local authority requirements,
 - EPA – Pollution control manual for urban stormwater,
 - LANDCOM NSW – Managing Urban Stormwater: Soils and Construction ("Blue Book")
- Erosion and sediment control **drawings and notes** are provided for the whole of the works. Should the Contractor stage these works then the design may be required to be modified. Variation to these details may require approval by the relevant authorities. The erosion and sediment control **plan** shall be implemented and adopted to meet the varying situations as work on site progresses.
- Maintain all erosion and sediment control devices to the satisfaction of the superintendent and the local authority.
- When stormwater pits are constructed prevent site runoff entering the pits unless silt fences are erected around pits.
- Minimise the area of site being disturbed at any one time.
- Protect all stockpiles of materials from scour and erosion. Do not stockpile loose material in roadways, near drainage pits or in watercourses.
- All soil and water control measures are to be put back in place at the end of each working day, and modified to best suit site conditions.
- Control water from upstream of the site such that it does not enter the disturbed site.
- All construction vehicles shall enter and exit the site via the temporary construction entry/exit.
- All vehicles leaving the site shall be cleaned and inspected before leaving.
- Maintain all stormwater pipes and pits clear of debris and sediment. Inspect stormwater system and clean out after each storm event.
- Clean out all erosion and sediment control devices after each storm event.

Sequence Of Works

- Prior to commencement of excavation the following soil management devices must be installed.
 - Construct silt fences below the site and across all potential runoff sites.
 - Construct temporary construction entry/exit and divert runoff to suitable control systems.
 - Construct measures to divert upstream flows into existing stormwater system.
 - Construct sedimentation traps/basin including outlet control and overflow.
 - Construct turf lined swales.
 - Provide sandbag sediment traps upstream of existing pits.
- Construct geotextile filter pit surround around all proposed pits as they are constructed.
- On completion of pavement provide sand bag kerb inlet sediment traps around pits.
- Provide and maintain a strip of turf on both sides of all roads after the construction of kerbs.

WATER QUALITY TESTING REQUIREMENTS

Prior to discharge of site stormwater, groundwater and seepage water into council's stormwater system, contractors must undertake water quality tests in conjunction with a suitably qualified environment consultant outlining the following:

- Compliance with the criteria of the Australian and New Zealand Guidelines for Fresh and Marine Water Quality (2000)
- If required subject to the environmental consultants advice, provide remedial measures to improve the quality of water that is to be discharged into Councils storm water drainage system. This should include comments from a suitably qualified environmental consultant confirming the suitability of these remedial measures to manage the water discharged from the site into Councils storm water drainage system. Outlining the proposed, ongoing monitoring, contingency plans and validation program that will be in place to continually monitor the quality of water discharged from this site. This should outline the frequency of water quality testing that will be undertaken by a suitably qualified environmental consultant.

EROSION AND SEDIMENT CONTROL LEGEND

- X X Siltation fence
- Stormwater pit with Geotextile filter surround
- Sandbag sediment trap

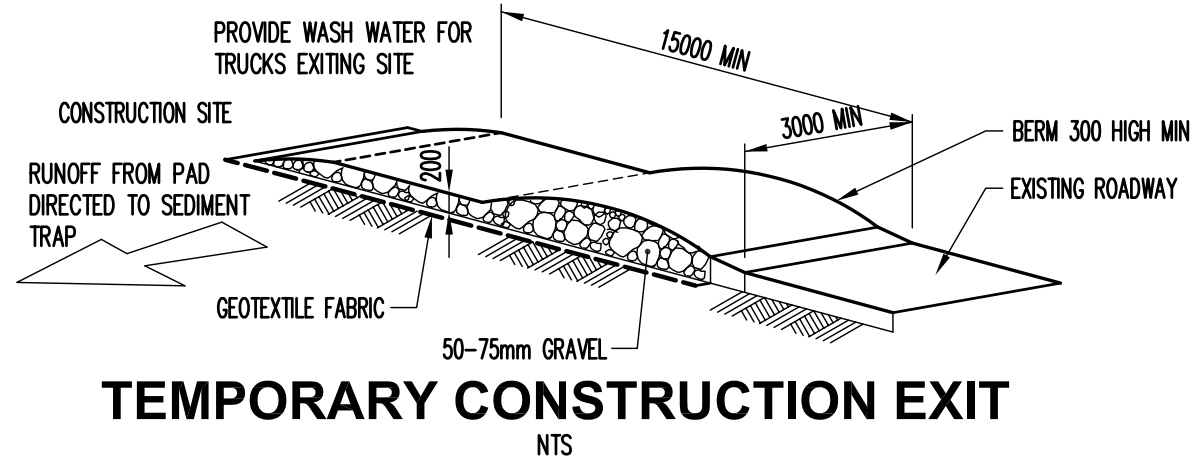
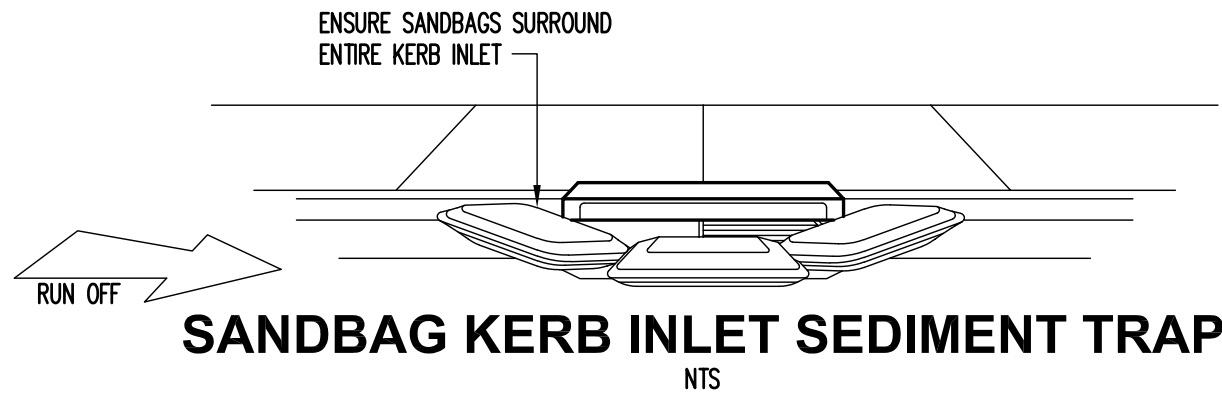
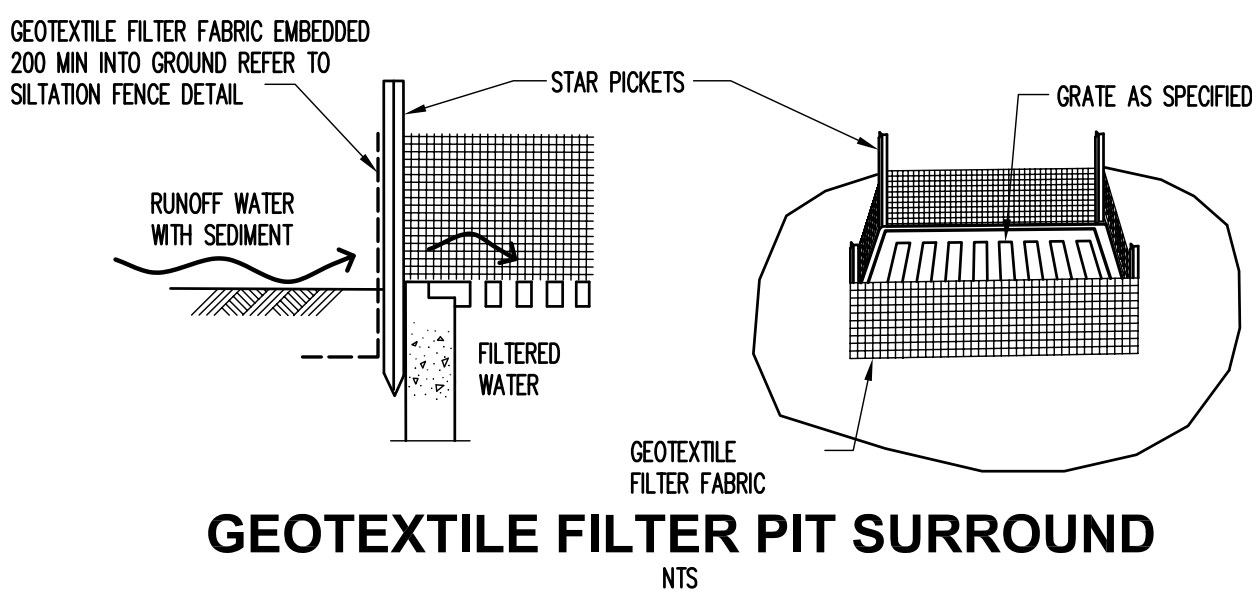
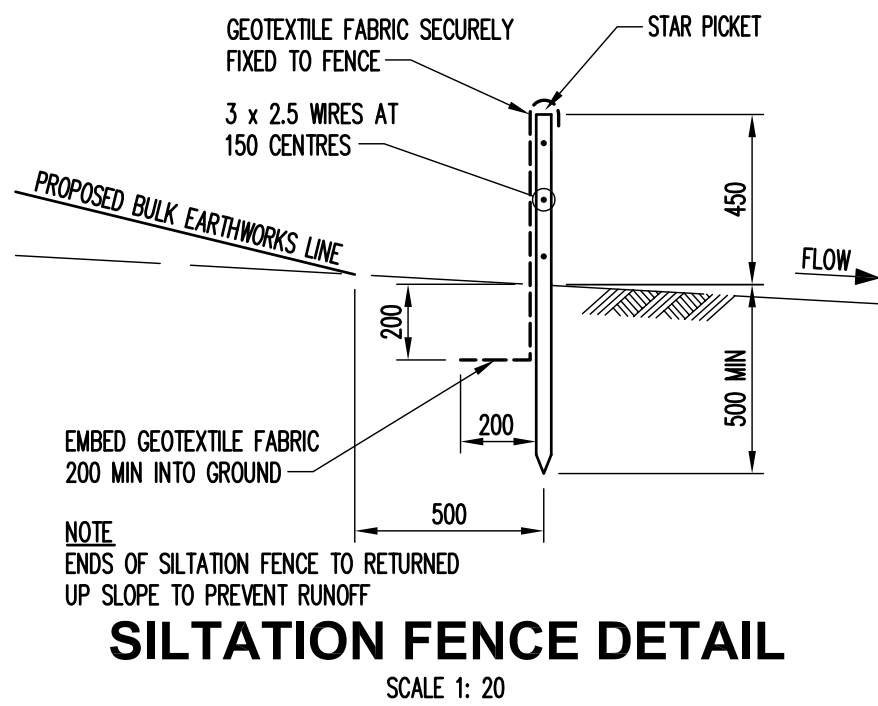
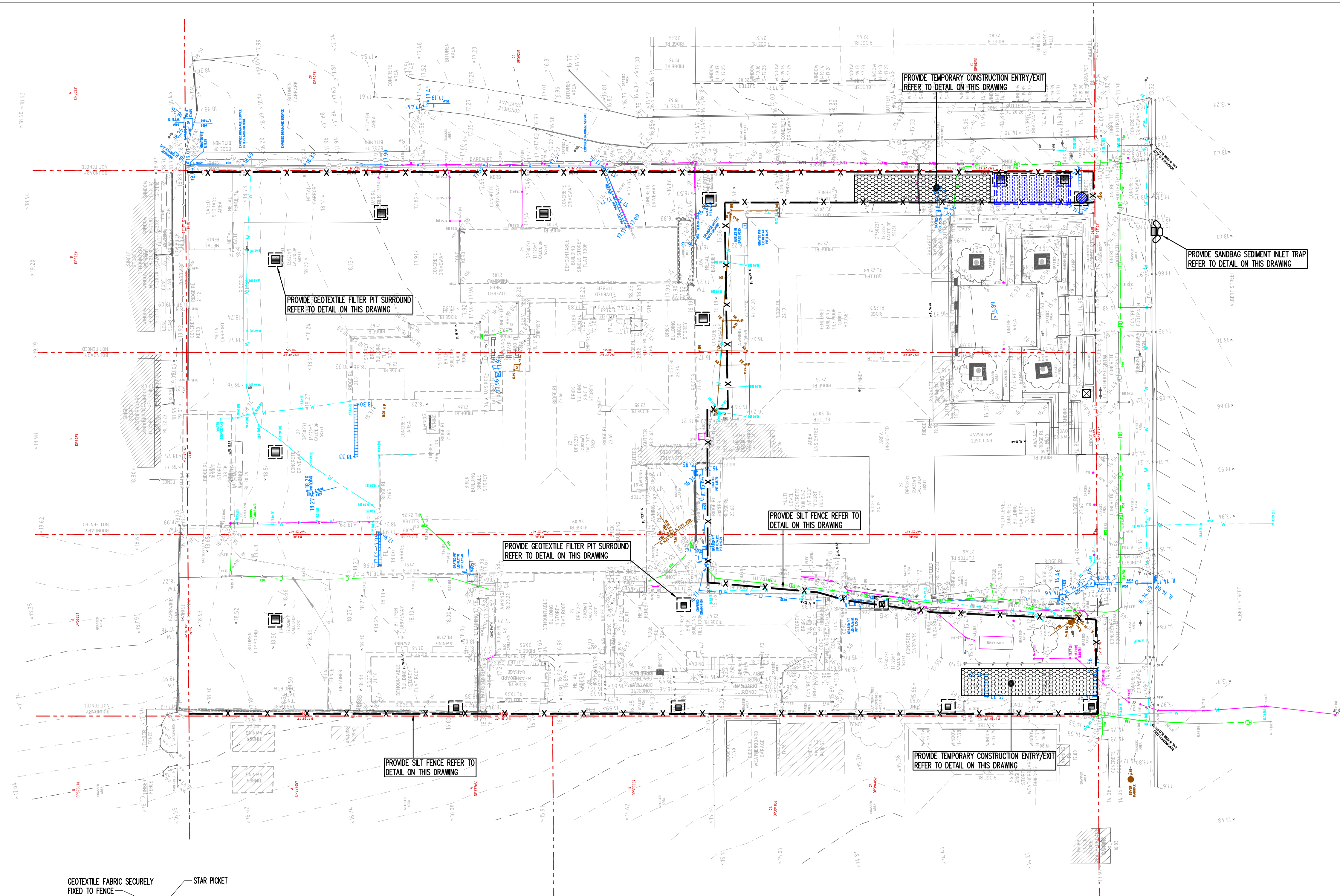

SCALE 1:250 0 2.5 5 7.5 10 12.5
AT ORIGINAL SIZE

DEVELOPMENT APPLICATION

Client



Project Manager



Architect



Group GSA Pty Ltd ABN 76 002 113 779
Level 7, 80 William St East Sydney NSW
T +612 9361 4144 www.groupgsa.com

Civil



612 9439 7288 | 48 Chandos Street St Leonards NSW 2065
Project

TAREE POLICE STATION

Location

83 ALBERT STREET, TAREE

Asset

TAREE POLICE STATION

Drawing Title

EROSION AND SEDIMENT CONTROL
PLAN

Phase	Scale	Plot Date	Drawn	Chk
DA	1:250@A1		VVW	NH
TTW Proj.	Drawing No	Revision		
181159	C02	P2		